



SERVICE PARTS LIST

BUL.54-46-0200

DRILL STAND

Catalog No. 3520

Starting
Serial No.

Both Model and Serial No. must be furnished to obtain correct parts.

| | |
|-----------------------|------------------|
| REVISED BUL 6118-1 | DATE Feb. '68 |
|-----------------------|------------------|

WIRING INSTR.

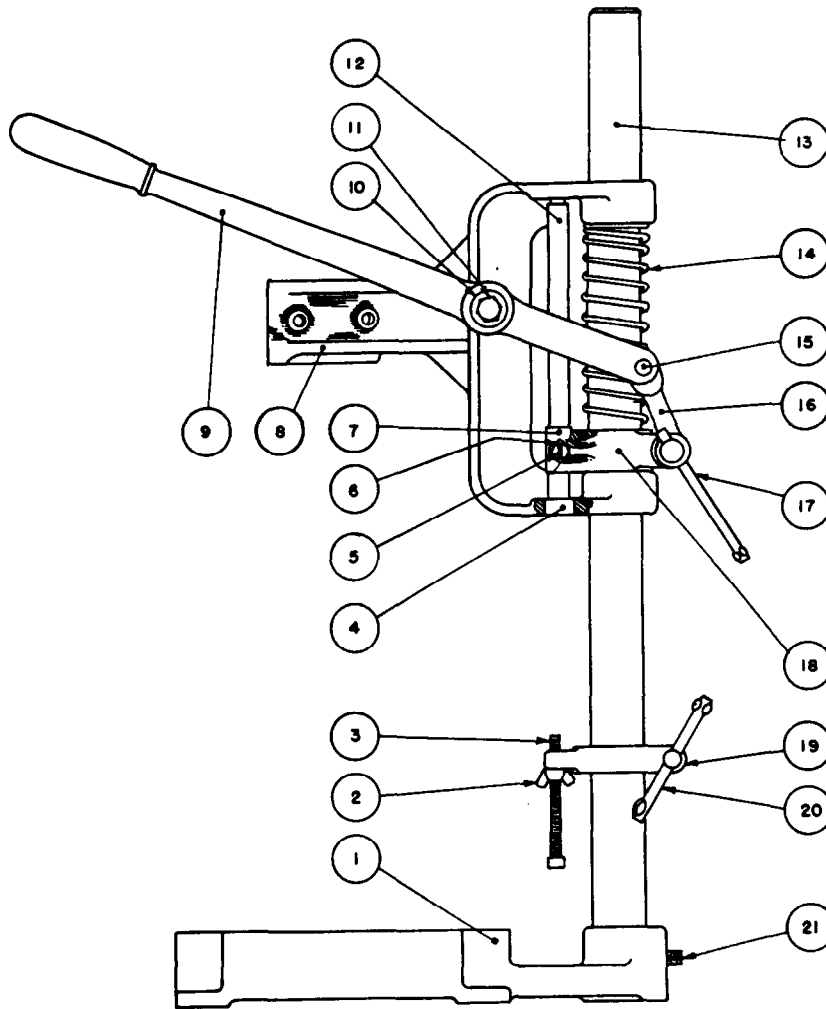

ILLUSTRATED PARTS

| FIG. | PART NO. | DESCRIPTION OF PART | FIG. | PART NO. | DESCRIPTION OF PART |
|------|------------|--|------|------------|----------------------------|
| 1 | 30-07-5201 | Base | 12 | 42-18-0050 | Guide Bar |
| 2 | 06-59-1500 | 5/16-18 Thr'd Collar Stop Set Sc. Wing Nut | 13 | 44-74-0080 | Post |
| 3 | 06-83-4550 | 5/16-18x3 Collar Adj. Sc. (Sq. Hd.) | 14 | 40-50-2700 | Coil Spring |
| 4 | 42-40-0150 | Guide Bar Lock Bushing | *15 | 06-65-2800 | 7/16x1-1/4 Drivlok Pin |
| 5 | 06-81-7850 | 1/4-20x1 Runner Adj. Sc. (Fil.Hd.) | 16 | 30-59-0241 | Handle Link |
| *6 | 06-55-1500 | 1/4-20 Lock Nut | 17 | 45-04-0130 | Bar Clamp T Screw Assembly |
| 7 | 44-98-0050 | Guide Bar Runner | 18 | 30-20-0141 | Bar Clamp |
| 8 | 30-24-0561 | Cradle | 19 | 30-86-0141 | Bar Collar Stop |
| 9 | 30-44-0181 | Handle | 20 | 45-04-0150 | Bar Collar Stop T Assembly |
| *10 | 45-88-5261 | Handle Swivel Screw Washer | 21 | 06-83-2940 | 3/8-16x1/2 Set Screw |
| 11 | 06-75-0600 | 3/8-16x1-3/4 Handle Swivel Screws | | | |

MISCELLANEOUS PARTS NOT SHOWN

| PART NO. | DESCRIPTION OF PART | PART NO. | DESCRIPTION OF PART |
|-------------|--------------------------------|-----------------|--------------------------------|
| 42-40-0140 | Swivel Screw Bushing | 49-96-0070 | Sawzall Socket Hd. Wrench |
| *06-77-0450 | 4x1/4 Driv-In Name Plate Scrs. | (2) *06-77-0450 | 4x1/4 Driv-In Spring Clip Scr. |
| 12-17-0600 | Name Plate | 45-04-0160 | Drill Clamping Screw |
| 42-70-0050 | Spring Clip | 49-96-0085 | 3/16 Socket Hd. Wrench |